

COPY

96
87

SHEET 1 OF 1 SHEET

ANNEXATION MAP NO. 42
COMMUNITY FACILITIES DISTRICT NO. 2016-3
(MAINTENANCE SERVICES)
CITY OF CORONA, COUNTY OF RIVERSIDE, STATE OF CALIFORNIA

THIS MAP SHOWS THE BOUNDARIES OF AREAS TO BE ANNEXED TO COMMUNITY FACILITIES DISTRICT NO. 2016-3 (MAINTENANCE SERVICES), OF THE CITY OF CORONA, COUNTY OF RIVERSIDE, STATE OF CALIFORNIA.

THE BOUNDARIES OF WHICH COMMUNITY FACILITIES DISTRICT ARE SHOWN AND DESCRIBED ON THE MAP THEREOF WHICH WAS PREVIOUSLY RECORDED ON NOVEMBER 7, 2016 IN BOOK 80 OF MAPS OF ASSESSMENT AND COMMUNITY FACILITIES DISTRICT AT PAGE 24 AND AS INSTRUMENT NO. 2016-0494014 IN THE OFFICE OF THE COUNTY RECORDER OF THE COUNTY OF RIVERSIDE, STATE OF CALIFORNIA.

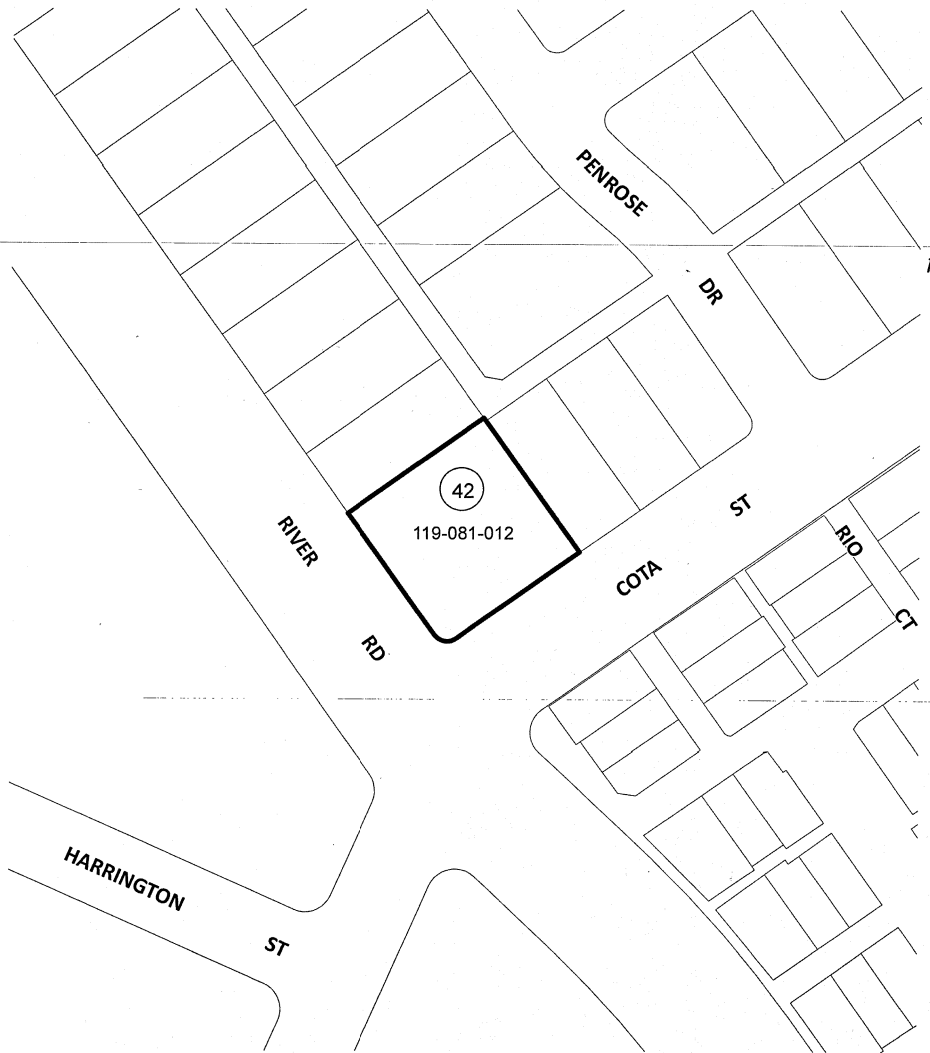

I HEREBY CERTIFY THAT THE WITHIN MAP SHOWING PROPOSED BOUNDARIES OF COMMUNITY FACILITIES DISTRICT NO. 2016-3 (MAINTENANCE SERVICES), OF THE CITY OF CORONA, COUNTY OF RIVERSIDE, STATE OF CALIFORNIA, WAS APPROVED BY THE CITY COUNCIL OF THE CITY OF CORONA AT A REGULAR MEETING THEREOF, HELD ON 6th DAY OF August 2025, BY ITS RESOLUTION NO. 2025-029

for Kate Duato
 CITY CLERK
 CITY OF CORONA

FILED IN THE OFFICE OF THE CITY CLERK, CITY OF CORONA, THIS 6th DAY OF August, 2025.

for Kate Duato
 CITY CLERK
 CITY OF CORONA

FILED THIS 8th DAY OF August, 2025, AT THE HOUR OF 9:29 O'CLOCK A.M. IN BOOK 96 OF MAPS OF ASSESSMENT AND COMMUNITY FACILITIES DISTRICTS AT PAGE 87 IN THE OFFICE OF THE COUNTY RECORDER, IN THE COUNTY OF RIVERSIDE, STATE OF CALIFORNIA.

FEE: \$ 9.46 NO.: 2025-0244488
 PETER ALDANA, ASSESSOR, COUNTY CLERK, RECORDER

BY: C. Gutierrez
 DEPUTY

LEGEND

- CITY BOUNDARY
- ANNEXATION AREA BOUNDARY
- PARCEL BOUNDARY
- XXX-XXX-XXX ASSESSOR PARCEL NUMBER
- (42) TAX ZONE

THIS ANNEXATION MAP CORRECTLY SHOWS THE LOT OR PARCEL OF LAND INCLUDED WITHIN THE BOUNDARIES OF THE COMMUNITY FACILITIES DISTRICT. FOR DETAILS CONCERNING THE LINES AND DIMENSIONS OF LOTS OR PARCEL REFER TO THE COUNTY ASSESSOR MAPS FOR FISCAL YEAR 2025-26.

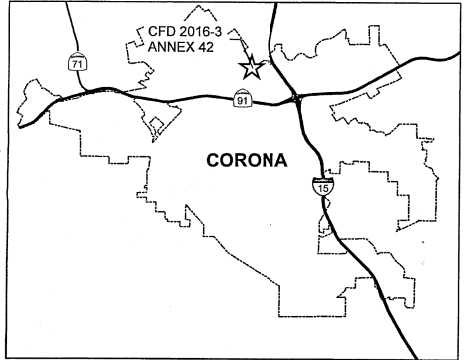

SPICER
 CONSULTING GROUP

